



# BRISBANE CANCER CONFERENCE

20  
25

**27 – 28 November 2025**

Brisbane Convention  
and Exhibition Centre

## PROGRAM



# Conference Sponsors

## Gold Sponsors



## Silver Sponsors



## Bronze Sponsors



## Other Sponsors



# Welcome

Dear Colleagues,

Welcome to the 12th Annual Brisbane Cancer Conference being held over 2 days on Thursday and Friday the 27-28th November 2025 at the Brisbane Convention and Exhibition Centre and supported by the Princess Alexandra Research Foundation (PARF) and Cancer Council Queensland (CCQ). This meeting is an opportunity to draw together cancer researchers in Brisbane, Queensland, Northern New South Wales and Darwin to advance collaborative efforts in cancer research.

The meeting comprises plenary lectures and workshops on recent scientific, technological, nursing, advocacy and medical developments in the diagnosis, treatment and research of malignant disease.

On Thursday 27th November, the meeting starts at 8.00am with Breast, Lung and Prostate Cancer, Survivorship and Immuno-oncology symposia running from 8 – 12 midday.

These will be followed by a further 'Cutting-Edge Research' symposium, lunch and then the first plenary lecture session of the meeting. Subsequently there will be workshops from 4.30–6.00pm.

The Gala dinner will be held on Thursday evening from 7.00pm offering the opportunity to socialise and network with colleagues and patient advocates/consumers.

The all-day session on Friday 28th November will include plenary lectures followed by workshops in the morning and afternoon.

A key session will be the lectures by Queensland oncology researchers starting at 12.30pm that have contributed to global advances in our understanding of the epidemiology, molecular biology and treatment of malignant disease.

Approximately 1,400 delegates registered for the event last year demonstrating the value of a truly multi-disciplinary annual Queensland Translational Cancer Research focused conference in Brisbane.

This conference is made possible through the support of PARF and CCQ, but also our many sponsors from Industry and the time and effort of the chairs who put the workshops together. I would also like to extend my thanks to the QUT CARP, the Centre for Genomics and Personalised Health and the Queensland Spatial Biology Centre, University of Queensland and Wesley Research Institute teams for their help during the meeting.

Best wishes for what should be an enjoyable and fulfilling two days.

Yours sincerely,

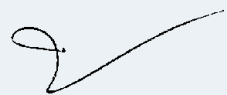

**Professor Ken O'Byrne**  
**Consultant Medical Oncologist**  
**and Clinical Scientist**

Princess Alexandra Hospital,  
Translational Research Institute and  
Queensland University of Technology



# Conference Program

THURSDAY 27 NOVEMBER, 2025

DAY  
1

## Registration opens (7am)

**Coffee cart** (sponsored by the Translational Research Institute Australia)

**Symposia (8.00–12.00 midday)** with sponsored Tea Breaks from 10.00–10.30

### Prostate Cancer

P6

**Chairs: Michael Huo, Aaron Hansen, Colleen Nelson**

- 08.00 Prostate brachytherapy update – Philip Chan
- 08.25 Developing a decentralized molecular device for prostate cancer liquid biopsies within a biosensor technology clinical validation framework – Kevin Koo
- 08.50 PSMA Theranostics Version 2.0 – Aravind Kumar
- 09.15 Results from the phase 1b dose escalation of 212Pb-ADVC001 in MCRPC – Joana Brilhante
- 09.40 Understanding the contribution of the tumour microenvironment to radiotherapy resistant cancer – Sugandha Bhatia

### 10.00 Morning tea (supported by AdvanCell)

- 10.30 Nanoknife salvage for radio-recurrent disease – John Yaxley
- 10.50 Unmasking mHSPC: The Era of Personalised Treatment – Tivya Kulasegeran
- 11.15 Comprehensive assessment of lower limb edema and its association with quality of life among men with prostate cancer – Sandra Jensen
- 11.40 Beyond the Biomarker Role of PSA – Jyotsna Batra

### Immuno-Oncology

P7 & P8

**Chairs: Antiopi Varelias, Rajiv Khanna**

- 08.00 Update on an acute oncology immune therapy toxicity clinic – Rebecca Donaldson
- 08.20 Personalised Immunotherapy Trials in Lymphoma – Joshua Tobin
- 08.40 Immune-tolerant persisters: A rare cell state underpins B-ALL relapse after CAR-T cell therapy – Jamie Kuzich
- 09.00 Mechanisms of immune control of AML – Megan Bywater
- 09.20 Ferroptosis: Double-Edged Sword in Cancer Immunotherapy – Di Yu
- 09.40 Impact of immunotherapy on Actinic Keratosis – Rahul Ladwa

### 10.00 Morning Tea (supported by ICON)

- 10.30 Epigenetic checkpoint blockade: A new booster to enhance immunogenicity – Sherry Tu
- 10.50 Advances in mRNA technologies to treat cancer – Tim Mercer
- 11.10 Eomesodermin+ CD4 T Cells are critical for curative immunotherapy outcomes – Ping Zhang
- 11.30 CAR-T cell therapy for glioblastoma – Paulo Martin

### Breast Cancer

P9

Clinical and Translational Breast Cancer Research

**Chairs: Pete Simpson, Jasotha Sanmugarajah**

- 08.00 Developing novel therapies to target aggressive Triple Negative Breast Cancer (TNBC) – Kum Kum Khanna
- 08.25 MDSCs contribute to the premetastatic niche formation: implications for pregnancy-associated breast cancer – David Gallego Ortega
- 08.55 When giants collide: linking obesity and cancer – Nils Halberg
- 09.20 From bench to bedside: targeting epigenetic pathways to overcome metastasis and immunotherapy resistance in TNBC – Sudha Rao
- 09.45 Optimising breast cancer care – Marina Reeves

### 10.10 Morning tea (supported by Daiichi Sankyo)

- 10.40 Changes in upper-body function in relation to lymphoedema in breast cancer – Hildegard Reul-Hirche
- 11.00 The 'why, what and how' of supporting people to exercise – Rosa Spence
- 11.20 Advancing liquid biopsy for breast cancer – a consumer's perspective – Barbara Fougere
- 11.40 Role of continuing care after breast cancer – Mater's statewide cancer survivorship service – Haakan Jakobsson

# Conference Program

THURSDAY 27 NOVEMBER, 2025

DAY  
1

Survivorship		P10 & P11
<b>Chairs: Harry Gasper, Laurelie Wishart</b>		
08.00	Update from the Queensland Collaborative for Cancer Survivorship (QCCS) – Kim Alexander	
08.15	Connections Help Young Regional and Remote People Living with Cancer – Jodi Sariman	
08.30	ARCHWAYS: AfteR Cancer Health & Wellness for Adolescents & Young Adults – Sandra Gleaves	
08.45	Supportive care needs of culturally and linguistically diverse communities affected by cancer and methods for gathering this information: A scoping review of the Australian context – Rhedyn Langley	
09.00	Food and nutrition insecurity in cancer survivorship: Findings from a scoping review – Susannah Ayre	
09.15	Beyond the physical: exploring the biopsychosocial needs of people affected by gynaecological cancers – Sonia Tomescu	
09.30	The financial burden of having a child with cancer – Megumi Lim	
09.45	Effectiveness and implementation of electronic patient-reported outcome measures in real-world routine cancer care for improving well-being: The pragmatic randomised controlled PROMISE trial – Ingrid Rowlands	
<b>10.00 Morning tea</b>		
<b>10.30 Deconstructed Reconstructed Survivorship Care Plans – Showcase of Perspectives</b>		
<b>Presenters and Panel</b>		
<ul style="list-style-type: none"><li>• Haematologist Perspectives – Dr Heshani Mediwake</li><li>• Nursing Perspectives – Leilani Way</li><li>• Community Support Perspectives – Chris Sibthorpe</li><li>• Lived Experience Perspectives – Vivian Crick</li><li>• Oncologist Perspectives – Dr Harry Gasper</li><li>• General Practitioner Perspective – Srishti Dutta</li><li>• Lived Experience Perspectives – Holly McMillan</li><li>• Allied Health Perspectives – Dr Laurelie Wishart</li></ul>		
<b>Lung Cancer</b> What's to be done with the nodule?		<b>S1</b>
<b>Chairs: Henry Marshall, Mark Adams, Kelly McGrath</b>		
08.00	Welcome	
08.05	Imaging guidelines for screening – Catherine Jones	
08.20	The ideal nodule Multi-Disciplinary Team – Gerry Olive	
08.35	Impact of screening on surgery – Paul Peters	
08.50	Role of radiotherapy in the age of screening – Kim Lin Chiew	
09.05	Novel biomarkers for detection of early disease – Mark Adams	
09.20	Trials for stage I-III NSCLC – Gary Ng	
09.35	The evolving role of the specialist lung cancer nurse – Cassie Mazza	
09.45	Consumer perspective – Anne Fidler	
<b>10.00 Morning tea (supported by AstraZeneca)</b>		
10.30	Early-stage small cell lung cancer management – Surein Arulananda	
10.55	LuCAP: key to improving standards of care in Thoracic Malignancies – Fraser Brims	
11.20	National Lung Cancer Screening Program: the first 4 months of therapy: MDT discussion – Henry Marshall	
11.50	Wrap up and close	
<b>12.00 Break</b>		
<b>Cutting Edge Research</b>		<b>Plaza Auditorium</b>
<b>Chair: Kenneth O'Byrne</b>		
12.15	The impact of metabolomics on the tumour microenvironment in solid tumours – Arutha Kulasinghe	
12.40	Loss of the DNA Damage Response, the key to ageing and cancer – Derek Richard	
13.05	Development of N-glycolylneuraminic acid as a carbohydrate cancer biomarker – Mike Jennings	
<b>Lunch (13.30 – 14.00)</b>		

# Conference Program

THURSDAY 27 NOVEMBER, 2025

DAY  
1

Plenary Lectures (14.00–16.00)		Plaza Auditorium
<b>Chairs: Damian Topp, Doreen Tapsall</b>		
14.00	Recent advances in high-risk cutaneous squamous cell carcinoma – Rahul Ladwa	
14.20	Precision medicine in paediatric and AYA sarcoma – Emmy Dorothy Grace Fleuren	
14.40	Playing on an uneven wicket? Mapping lung cancer services across Australia – Fraser Brims	
15.00	The Australian Cancer Atlas: Enabling Discovery, Decision-Making, and Digital Innovation – Peter Baade	
15.20	ACRF Centre for Optimised Cancer Therapy – Vicki Whitehall	
15.40	Bridge Building: Cancer Nurses at the Intersection of Clinical and Genetic Care – Kim Alexander	
<b>Refreshments (16.00–16.30)</b>		
Parallel Workshops (16.30–18.00)		
Bone and soft tissue tumours		P6
<b>Chair: Vladimir Andelkovic</b>		
16.30	Phosphoproteomics in osteosarcoma – Emmy DG Fleuren	
16.48	Pilot study to assess the efficacy of Local vs Systemic doxorubicin delivery in an orthotopic humanized Rat osteosarcoma model – Jonathan Gospos	
17.06	CAR-NK approach for sarcomas – Allie Lam	
17.24	Cryotherapy in bone and soft tissue tumours – Mark Paxton	
17.42	Trials and distributions in sarcoma – Rick Walker	
Genomics		P7
<b>Chairs: Bonnie Wong, Quan Nguyen, Katie Nones</b>		
16.30	Neoantigen landscape in Paediatric Brain Cancer – Kiran Gnana	
16.47	The natural history of primary melanoma and its relationship to recurrence – Sam Tan	
17.04	BRCA1 methylation dynamics and PARP inhibitor resistance in ovarian cancer – Olga Kondrashova	
17.21	Targeting DNA Replication in Cancer with Nanopore Sequencing and AI – Mathew Jones	
17.38	Genomic Landscapes of Prostate Cancer: Pathways to Precision – Jyotsna Batra	
Head and neck cancer		P8
<b>Chairs: Margaret McGrath, Catherine Barnett, Rahul Ladwa</b>		
16.30	Current status of Transoral Robotic Surgery (TORS): technical aspects and patient selection – Ryan Sommerville	
16.40	Potential clinical utility of small extracellular vesicles derived from head and neck tumours – Abolfazl Jangholi	
16.50	Predictive value of salivary HPV testing – Sreedevi Damodaran	
17.00	Voices from the frontline: informing allied health supportive care models for head and neck cancer patients receiving immunotherapy – Nicole O'Donnell	
17.10	Adjuvant treatment following TORS: current treatment paradigm – Charles Lin	
17.20	Taste changes and dietary intake in patients with head and neck cancer post chemoradiation according to genetically determined Taster Status – Teresa Brown	
17.30	Discovery Spatial Proteomics in Head and Neck Cancer – Chin Wee Tan	
	Discussion 20 minutes	
Urothelial malignancies		P9
<b>Chairs: Jeff Goh, Kate Cuff</b>		
16.30	Updates on systemic treatment for metastatic renal cell cancer – Shivanshan Pathmanathan	
16.50	Updates on adjuvant treatment for resected high risk RCC, including the recently presented RAMPART data – Kate Cuff	
17.10	Incorporation of ADCs into the treatment paradigm for muscle invasive & metastatic bladder cancer – Jeff Goh	
17.30	New SRS/SABR techniques for oligometastatic renal cell cancer & recurrent renal lesions – Michael Huo	
17.50	Concluding remarks	

# Conference Program

THURSDAY 27 NOVEMBER, 2025

DAY  
1

## Clinical trials

P10

**Chairs: Dan McKavanagh, Marissa Ryan**

- |       |   |
|-------|---|
| 16.30 | What clinical trials have taught us about medicinal cannabis – Janet Hardy  |
| 16.47 | Tumour-infiltrating lymphocyte (TIL) therapy for previously untreated, unresectable, or metastatic melanoma: Clinical response and challenges – Snezana Tripkovic |
| 17.04 | Unmasking immune effector cell-associated HLH: A post-CAR T-cell therapy complication and its management – Vivian Day   |
| 17.21 | Harnessing digital technology for cancer clinical trials governance and efficiency – Sarah Mott   |
| 17.38 | Sooner rather than later: Early pharmacy input into trials compounding for a well-designed pharmacy manual – Anna Shi   |
| 17.55 | Concluding remarks  |

## Survivorship

P11

The Queensland Collaborative for Cancer Survivorship: Survivorship Research Outcomes

**Chairs: Holly McMillan, Leilani Bongay**

- |       |  |
|-------|--|
| 16.30 | Aligning Research with Real-World Needs: Top Priorities for Childhood Cancer in Australia – Gayani De Silva  |
| 16.45 | Health Interventions and Alcohol Use in Cancer: A Systematic Review and Meta-Analysis – Manuela Beaty  |
| 17.00 | Cancer-related lymphoedema: Updated incidence estimates and the preventive effect of exercise – evidence from two systematic reviews and meta-analyses – Melanie Plinsinga |
| 17.30 | Equipping primary care dietitians: Co-designing a resource for cancer nutrition care – Henriette Ryding  |
| 17.45 | Understanding the needs, preferences and ideas for a peer support group for women affected by cancer: Co-design Phase 1 – Xanthia Bourdaniotis                             |

**Gala Dinner (7.15pm 'til late)**

Boulevard Room



# Conference Program

FRIDAY 28 NOVEMBER, 2025

DAY  
2

## Registration opens (7am)

## Plenary Lectures (8.00–10.00)

Plaza Auditorium

**Chairs: Sandro Porceddu, Melissa Eastgate**

08.00	Lives lost, work interrupted: estimating paid and unpaid productivity losses from cancer mortality – Dan Lindsay
08.25	Survivorship: The Long Game: Building better futures for children, adolescents and young adults after cancer – Natalie Bradford
08.50	Sign Me Up - If it was only that easy: AYA Clinical Trials in Queensland – Rick Walker
09.15	Targeting the nuclear protein BANF1 for cancer prevention and treatment – Emma Bolderson
09.40	Supportive care needs of culturally and linguistically diverse communities affected by cancer and methods for gathering this information: A scoping review of the Australian context – Rhedyn Langley

## Parallel Workshops (10.00–12.00)

### Pharmacy Research & Innovation

P6

**Chairs: Dan McKavanagh, Marissa Ryan**

10.00	Influence of concomitant medication use and time of administration on response to immune checkpoint inhibitors for cancer treatment – Linzy Sneyd
10.17	Evaluation of the introduction of a Cancer Treatment Diary Card (PROMs tool) for the monitoring of treatment related toxicity – Lesley Dawson
10.34	Incidence of febrile neutropenia and time to count recovery in AML patients receiving HiDAC consolidation: a 2 year follow up from implementing pegfilgrastim – Michael Whordley
10.51	CaRE-Vid: Cancer Resource Education via Video – Tara Isaacs
11.08	Repurposing of alpha-1 adrenoceptor antagonists in prostate cancer – Liam King
11.25	From Headland to Hinterland: Cancer Care in Northern NSW – Stacey Letton and Jill McDonnell
11.42	Darling Downs Cancer Service – Braedon Denham
11.59	Concluding remarks

### Brain tumours

P7

**Chairs: Mark Pinkham, Kate Cuff, Hamish Alexander**

10.00	Overview of current and upcoming clinical neuro-oncology trials in Brisbane – Betty Zang
10.17	Responding to the needs of people with brain tumour; next steps – Katarzyna Lion
10.34	Inhibiting DNA damage repair by combining radiation with palbociclib improves survival in orthotopic PDX mouse model of medulloblastoma – Samreen Shaikh
10.51	Mechanobiology of Melanoma: Understanding How Tumour Cells Survive Metastasis – Sam Stehbens
11.08	Radiomics and Machine Learning for the Prediction of Local Control in Melanoma Brain Metastases treated with Stereotactic Radiosurgery – Ravi Marwah
11.25	Radiomics to predict survival and molecular status from pre-treatment imaging in patients with glioma – Aleksandra Kazi
11.42	Post-operative aphasia following negative language mapping in low-grade glioma resection: A SCAN Network hypothesis – Joseph Garcia Redmond

### 3-D Cancer models

P8

**Chairs: Lisa Philp, Robert Ju, Lauren Aoude**

10.30	3-D Cancer Models Workshop Opening
10.35	Studying mitochondrial morphodynamics in confined environments – Alex Libert
10.45	Modelling the vasculature in disease with 3D microfluidic devices – Tish Essebier
10.55	Targeting an adaptive neovascular response of the tumour microenvironment to treat advanced prostate cancer – Brooke Landon
11.05	Bioengineered 3D models of breast cancer to assess therapy response – Anu Thomas Koikaletu
11.15	The Journey of Developing a Patient-Derived 3D Breast Cancer Model – Binny Jaradi
11.25	Patient Derived Organoids as tools for development of new therapies for oesophageal cancer – Alexis de Sa Ribeiro Do Bonfim Melo
11.35	Shared molecular regulation of quiescence in neural and glioma stem cells reveals therapeutic vulnerabilities – Chandra Choudhury
11.45	Closing Discussion and Remarks – Lisa Philp, Robert Ju, Lauren Aoude

# Conference Program

FRIDAY 28 NOVEMBER, 2025

DAY  
2

## Gynae-oncology P9

**Chairs: Carlos Salomon, Kathryn Middleton, John Hooper**

- 10.00 Treatment induced methylation in ovarian cancer – Jacinta Simmons
- 10.17 Optimisation of metastatic endometrial cancer treatment using patient-derived organoids – Asmerom Senegal
- 10.34 Novel therapeutic approach to overcome chemotherapy resistance in high-grade serous ovarian cancers – Prahlad Rangina
- 10.51 Clinically scalable engineering of bio-manufactured extracellular vesicles for selective delivery to ovarian cancer in patient derived models – Nihar Godbole
- 11.08 Updates from ESMO – Sean Hill
- 11.25 DNA methylation patterns in ovarian cancer – Dominic Guanzon
- 11.42 HER2 positive Uterine Serous Papillary Carcinoma (USPC) and endometrial cancer and HER2 targeted therapy – Betty Zhang

## Thoracic Malignancies P10

**Chairs: Tim Edwards, Zulfiqar Otty, Rebecca Kimberley**

- 10.00 ESMO updates on NSCLC and mesothelioma – Kelly McGrath
- 10.20 Clinical trials in locally advanced and advanced NSCLC – Robert Mason
- 10.40 Novel diagnostic procedures – David Fielding
- 10.55 Cost-Effectiveness of Genomic Testing in Advanced NSCLC: Four Strategies Compared – Louisa Collins
- 11.10 Immuno-metabolic profiling of the lung cancer tumour microenvironment – James Monkman
- 11.25 Targeting DNA repair in lung cancer – Amila Suraweera
- 11.40 The role of the nurse practitioner in audit and quality of care delivery – Rebecca Kimberley

## Youth Cancer workshop P11

**Strengthening AYA Futures: A Statewide Model of Wrap around Cancer Care  
Queensland Youth Cancer Service (QYCS)**

**Chairs: Rick Walker, Katie Lindeberg**

- 10.00 Introduction to QYCS – Katie Lindeberg
- 10.20 Nuts and Bolts – Rick Walker
- 10.40 AYA Development Including the Patient Voice – Kylie McPaul
- 11.00 Fertility – Tracy Till
- 11.20 Survivorship in AYA Cancer – Sandra Gleaves
- 11.40 Discussion and closing remarks

## Immuno-oncology S1

**Chairs: Rajiv Khanna, Antiopi Varelias**

- 10.00 Harnessing Cytokine Signaling to Overcome Immunotherapy Resistance in Cancer – Nicholas Huntington
- 10.20 Current challenges in delivering mRNA to the immune compartment – Nigel McMillan
- 10.40 Mechanisms of immune regulation in head and neck cancers – Janin Chandra
- 11.00 Cancer Immunotherapies – Kristen Radford
- 11.20 Novel biologics for cancer immunotherapy – Michelle Wykes
- 11.40 Weaponizing natural killer cells for solid cancer immunotherapy – Joshua Wong

**Lunch (12.00–12.30)**

# Conference Program

FRIDAY 28 NOVEMBER, 2025

DAY  
2

Plenary Lectures (12.30–14.10)		Plaza Auditorium
<b>Chairs: Helen Benham, Ian Irving</b>		
12.30	The challenge of skin field cancerisation – Kiarash Khosrotehrani	
12.50	Epithelial Mesenchymal Transition for clinicians – Rik Thompson	
13.10	DREAM3R: Durvalumab with chemotherapy as first-line treatment in advanced pleural mesothelioma, A phase 3 randomized trial – Kenneth O'Byrne	
13.30	Early transitional chemical changes on MRI indicative of breast cancer development two to six years ahead of current methods: Ten-year longitudinal clinical trial – Carolyn Mountford	
13.50	Does adding exercise to chemotherapy for newly diagnosed ovarian cancer impact survival and quality of life? – Sandi Hayes	
<b>Refreshments (14.00–14.30)</b>		
<b>Parallel Workshops (14.30–16.00)</b>		
<b>Theranostics</b>		<b>P6</b>
<b>Chairs: David Pattison, Roslyn Francis</b>		
14.30	Practice-changing clinical trials in theranostics: an update for the medical oncologist – Aravind Ravi Kumar	
14.45	The evolving role of molecular imaging in enhancing outcomes in theranostics – Roslyn Francis	
15.00	A practical guide to implementing theranostics in Medical Oncology practice – Bek Orford	
15.15	Chemistry to clinical trials: insights into the radiopharmaceutical development pipeline at AIBN – Brett Paterson	
15.30	Future direction of theranostics: alpha therapy & beyond – Nattakorn Dhantravan	
15.45	α-Therapy and Combination Strategies to Overcome Resistance and Enhance Clinical Outcomes in Prostate Cancer – Stephen Rose	
<b>Palliative Care</b>		<b>P7</b>
<b>Chairs: Ben Gunawan, Phillip Good</b>		
14.30	Overcoming challenges, key considerations and recommendations for pediatric palliative care cannabis trials – Alison Bowers	
14.47	The Teletrial Tapestry: weaving together Queensland's Palliative Care Teletrial Network – Claire Stokes	
15.04	Characteristics and incidence of patients discharged from a community specialist palliative care service – Owen Bourne	
15.21	Exploring the influence of mindfulness practice on care provision in palliative care: a qualitative study – David Ruzicka	
15.38	Dissatisfaction in a palliative care service – Phillip Good	
15.55	Closing remarks	
<b>GI malignancies</b>		<b>P8</b>
<b>Chairs: Vicki Whitehall, Mark Bettington</b>		
14.30	Aspirin and Regorafenib Synergise to Reduce Colorectal Cancer Growth – Troy Dumenil	
14.45	Genome Wide Analysis of Metastatic Colorectal Cancer – Catherine Bond	
15.00	Updates on systemic therapy for colorectal cancer – Michael Fernando	
15.15	Oesophageal cancer – Lauren Aoude	
15.30	From Maps to Meaning: What Spatial Patterns Tell Us About Liver Cancer in Australia – Charlotte Bainomugisa	
15.45	Endoscopic management of colonic neoplasia in 2025: Polyps and paradigm shifts – Tim O'Sullivan	
<b>Multiomics</b>		<b>P9</b>
<b>Chairs: Arutha Kulasinghe, Clara Lawler</b>		
14.30	Immuno-metabolic profiling of high grade serous ovarian cancer – Naomi Berrell	
14.45	Predictors of immunotherapy mapped at spatial single-cell resolution – Dharmesh Bhuvu	
15.00	Foundation Models and H&E Image Gene Prediction – Joey Li	
15.15	Large-scale cell atlases as a foundation for understanding human disease – Amanda Oliver	
15.30	Predicting Treatment Response in Early and Late-Stage Lung Cancers Using Spatial Proteomics – Aaron Kilgallon	
15.45	Panel discussion	

# Conference Program

FRIDAY 28 NOVEMBER, 2025

DAY  
2

## Melanoma and skin cancer

P10

**Chairs: Glen Boyle, Laura Sormani, Wen Xu**

- |       |   |
|-------|---|
| 14.30 | Cyclic host-defense peptides kill proliferative, non-proliferative and drug-resistant melanoma cells without inducing resistance – Aurelie Benfield |
| 14.41 | Precision diagnostics for early melanoma detection using spatial biology and AI-guided image analysis – Wendy Kao                                   |
| 14.52 | Spatial assessment of Ki67 to correlate with MITF in primary and metastatic melanoma – Jordan Kumar   |
| 15.03 | Why are thick melanomas lethal? Spatial profiling of thin versus thick melanoma – Samuel Tan  |
| 15.14 | Role of immature myeloid cells in melanoma establishment – Abby Xiaoyu Hou  |
| 15.25 | Deep Imaging Phenotype for melanoma risk assessment – Clare Pimiero   |
| 15.36 | Genetic Susceptibility in Multiple Primary Melanoma – Peter Johansson   |
| 15.47 | CWAS meta-analysis provides new insights into uveal melanoma risk – Huanwei Wang  |
| 15.58 | Concluding remarks  |

## Breast cancer

New Frontiers in Breast Cancer Research

P11

**Chairs: Charles Bidgood, Vaibhavi Joshi**

- |       |   |
|-------|---|
| 14.30 | Temporal and cell trajectory analysis in breast cancer progression – Andrew Newman  |
| 14.48 | Targeting the POLR2J4 lncRNA enhances PARP inhibitor sensitivity in TNBC – Xue Lu   |
| 15.06 | Enhancing the anti-TNBC activity of NK cells through genome editing – Elaina Coleman  |
| 15.24 | Defining the Triple Negative Breast Cancer tumour microenvironment with high-plex multiplexed immunofluorescence – Cameron Williams |
| 15.42 | Copy number alterations in relation to breast cancer immunotherapy – Erika Morera   |
| 15.57 | Concluding remarks  |

## Haematology

S1

**Chairs: Stephen Boyle, Rakin Chowdhury, Colm Keane**

- |       |  |
|-------|--|
| 14.30 | STING agonists in Acute Myeloid Leukaemia – Yin Yuan   |
| 14.50 | Immuno-genetic biomarkers of response in a prospective study of immune checkpoint therapy in primary CNS lymphoma – Nella Tuczko |
| 15.10 | Leukaemia STEMming from MPN: unraveling the loss of HSC heterogeneity during transformation – Julian Grabek                      |
| 15.30 | Molecular haematology in Qld: Present challenges and future developments in the diagnostic laboratory – Michael Tallack          |

## Refreshments (16.00)

## Plenary session (16.15 – 17.15)

Novel Omics as diagnostic, prognostic and predictive tests to guide therapy

Plaza Auditorium

**Chair: Shivashankar Nagaraj, Chamindie Punyadeera**

- |       |  |
|-------|--|
| 16.15 | Cancer Genomics in Queensland – Paul Leo   |
| 16.30 | Mesothelioma: Linking Tumour and Liquid Biopsy Response Biomarkers – Kenneth O'Byrne                       |
| 16.45 | Early-Stage Multi-Cancer Detection through a Plasma Extracellular Vesicle Protein Signature – Richard Lobb |
| 17.00 | Q&A  |

## Wine and cheese (17.15–18.00)

# Venue Floor Plans

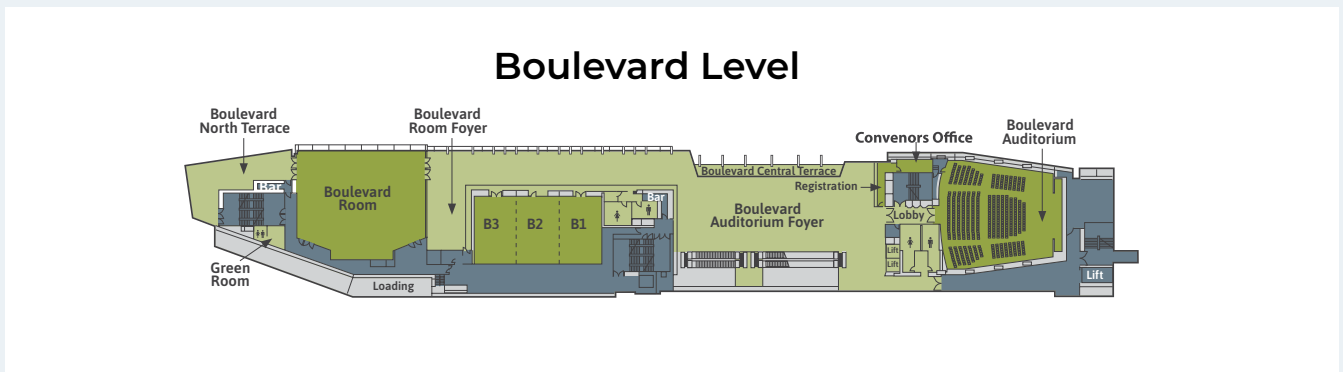
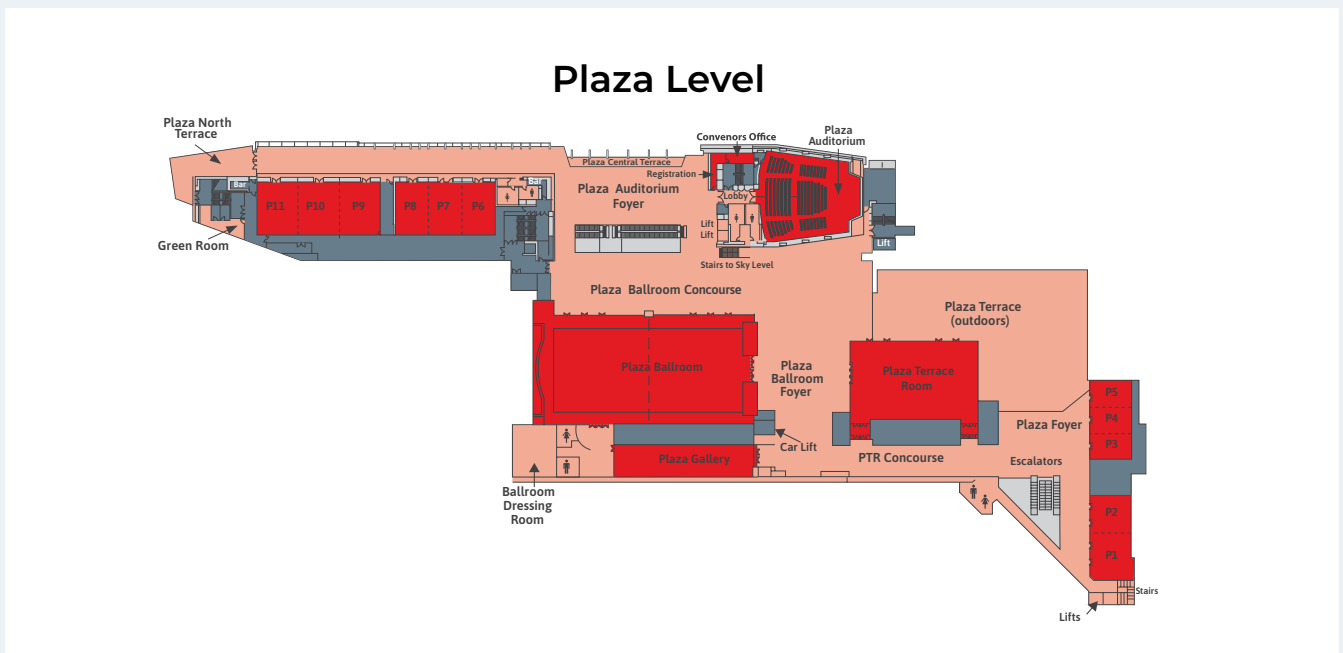
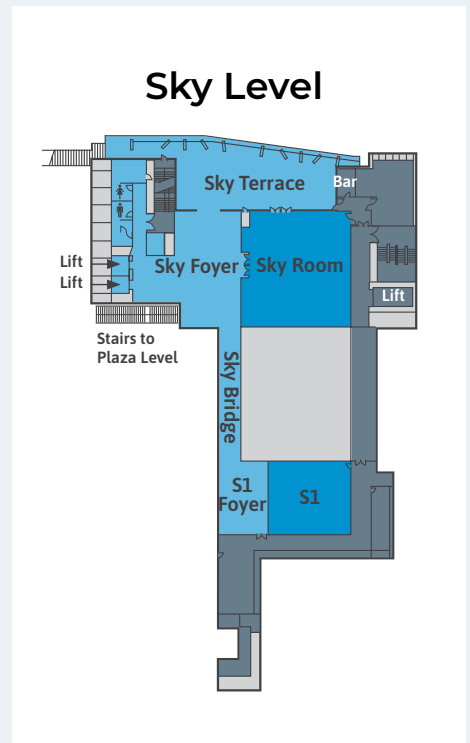
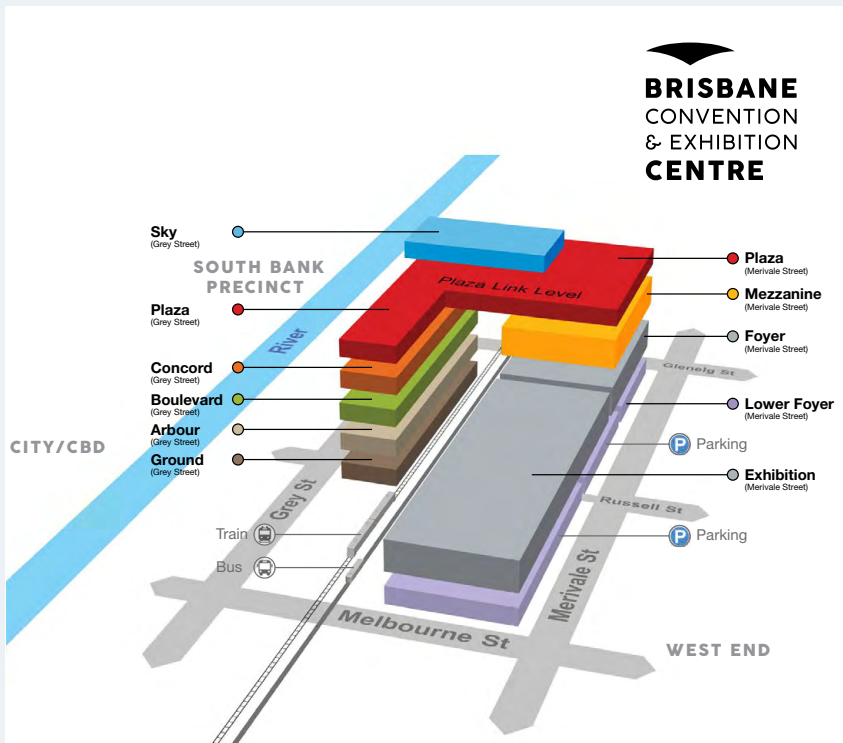

# Sponsor Floor Plan

<b>AstraZeneca</b>	<b>1</b>
<b>BMS</b>	<b>2</b>
<b>BeOne</b>	<b>3</b>
<b>Cancer Council Queensland</b>	<b>4</b>
<b>Johnson &amp; Johnson</b>	<b>5</b>
<b>Roche</b>	<b>6</b>
<b>MSD</b>	<b>7</b>
<b>Amgen</b>	<b>8</b>
<b>Ariceum</b>	<b>9</b>
<b>Arrotex</b>	<b>10</b>
<b>Turner Freeman Lawyers</b>	<b>11</b>
<b>Slater Gordon Lawyers</b>	<b>12</b>
<b>Pfizer</b>	<b>13</b>
<b>Sun Pharma</b>	<b>14</b>
<b>Medison</b>	<b>15</b>
<b>Lung Foundation Australia</b>	<b>16</b>
<b>Lilly Oncology</b>	<b>17</b>
<b>GSK</b>	<b>18</b>
<b>Novartis</b>	<b>19</b>
<b>Merck</b>	<b>20</b>
<b>Astellas</b>	<b>21</b>
<b>Bayer</b>	<b>22</b>
<b>Eisai</b>	<b>23</b>
<b>Boehringer Ingelheim</b>	<b>24</b>
<b>Ipsen</b>	<b>25</b>
<b>Baxter</b>	<b>26</b>

